



# ARDEX X 60 PU FLEX

## Fix all Tile Types to Problematic Substrates

### Two-Part Reaction Resin Tile Adhesive

Ideal for fixing all tile types to problematic substrates such as fibreglass, steel and PVC coverings, and for tiling in areas sensitive to moisture.



**NO PRIMING  
REQUIRED**

**ARDEX X 60 PU FLEX is a two-part polyurethane adhesive, ideal for fixing all tile types to problematic substrates such as fibreglass and steel. It is also suitable for adhering natural stone, aluminium and PVC coverings, and is water resistant when fully cured.**

ARDEX X 60 PU FLEX is suitable for use in exterior areas, and can also be used on interior substrates sensitive to moisture e.g. particle boards, plywood, plasterboard, gypsum fibre boards, fibre cement boards and plaster slabs.

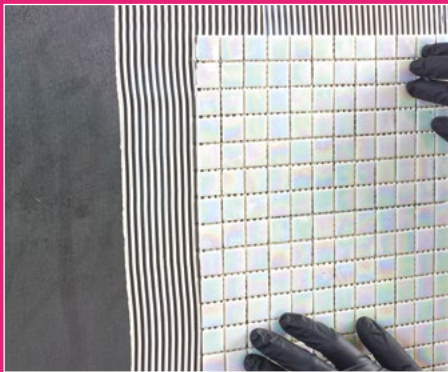

**STEEL**



**PVC COVERINGS**



**EXISTING TILES**



**FIBREGLASS (GRP)**

# ARDEX X 60 PU FLEX

## Two-Part Reaction Resin Tile Adhesive



<b>Pot Life:</b>	45 minutes
<b>Working Time:</b>	60 minutes
<b>Light Foot Traffic:</b>	3 hours
<b>Grout After:</b>	3 hours
<b>Coverage:</b>	Up to 1.92m <sup>2</sup>



**Application:** Easy to apply, with no special tools required.

### Mixing:

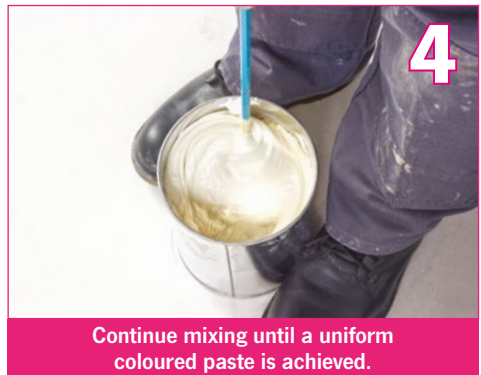

# ARDEX X 60 PU FLEX



## Two-Part Reaction Resin Tile Adhesive for Problematic Substrates



ARDEX UK Limited  
01440 714939

 @ARDEXUKtiling  
info@ardex.co.uk

 ARDEX UK  
www.ardex.co.uk